

Planning Permit No. **A/610/89**

**APPROVED**

Subject to the conditions in this office letter.

No. **A/582/89/12-7-88**

FOR MEMBER SECRETARY  
MADRAS METROPOLITAN DEVELOPMENT AUTHORITY

7.7.88

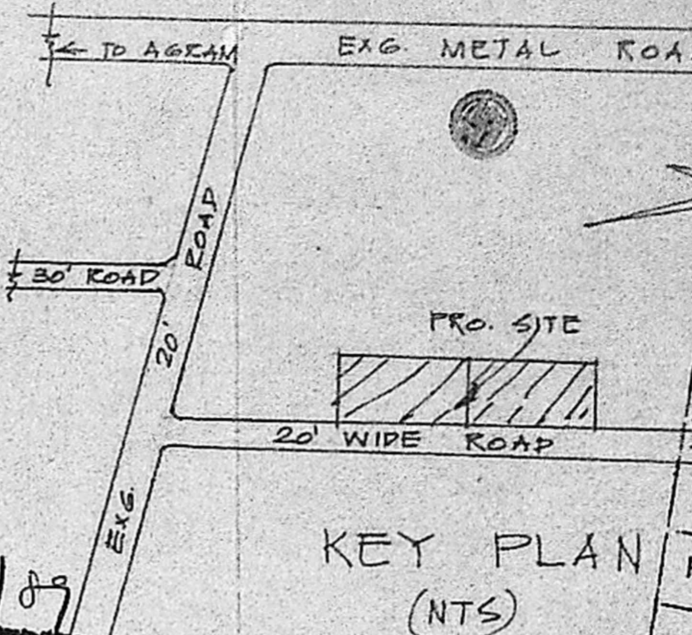

MMDA  
C.No. **A/582/89/12-7-88**  
PART I  
PART II  
A.P.  
D.P.

REFERENCE

DOOR	100 x 213
DOOR	91 x 198
DOOR	75 x 183
WINDOW	91 x 135
WINDOW	135 x 135
WINDOW	183 x 135
Y-VENT	75 x 61
V1-VENT	122 x 45
J. JOLLY	152 x 61

STAIR CASE DETAILS

WIDTH 75CMS.

RAISE 17CMS.

TREAD 23CMS.

COLOUR INDEX

PROPOSED ROAD

SITE BOUNDARY

TOTAL EXTENT	4400 SQ. FT.	409 SQ. MTS.
PROPOSED PLINTH	1300 SQ. FT.	121 SQ. MTS.
OPEN SPACE	3100 SQ. FT.	288 SQ. MTS.
FSI	0.30	
COVERAGE	30%	

PLAN SHOWING THE PROPOSED CONSTRUCTION OF A HOUSE IN S.No 374/IA OF SELAIYUR VILLAGE - EAST TAMBARAM. TAMBARAM MUNICIPAL LIMITS. SAIPAPET TALUK. CHINGLEPUT DISTRICT.

SCALE 1:100 & 200

*Rajmaly*  
(Rm JEYARAJ) W.G. CDR.  
OWNER

*K. Komarajan*  
K. Krishna Rajan, L.C.B.  
CONSULTING ENG. NEER.  
LICEN TO SURVEY R.  
TAMBARAM MUNICIPALITY  
1, BRINDHAN AVENUE, KEN. DIST.  
TAMBARAM WEST  
MADRAS-600045